

2015 Promising Pathways 8th Annual Conference

Florida Gulf Coast University

Estero, FL

April 11th, 2015



a conference for families, educators, and
health care professionals addressing
autism spectrum disorders



Keynote Speaker:
Chantal Sicile-Kira
Autism College



PROMISING PATHWAYS

Welcome to Promising Pathways

April 11, 2015

Dear Conference Attendees:

The Promising Pathways planning committee is pleased to present our 8th Annual Conference on Best Practice in Autism, with keynote speaker Chantal Sicile-Kira, author, speaker, consultant, and founder of Autism College.

The conference is a community event, provided free to the public, and coordinated by a regional volunteer planning committee including parents of children with autism and interested community members, as well as representatives from the Center for Autism and Related Disabilities, Florida Gulf Coast University, Lee County School District, Collier County Public Schools, and Family Care Council. We are thankful for the time and talents our committee has provided.

Each year we welcome 400 parents, educators, healthcare workers and community members interested in serving individuals with autism to this conference. We have never charged for attendance. It is only due to the generosity of community and business members who sponsor this event that we are able to continue offering the conference at no cost to attendees. While we do not specifically endorse sponsors, we do encourage you to take the time to visit our vendors and learn more about the programs and services available in our area. If you are interested in supporting next year's conference or joining our planning committee, please contact us.

We hope that the investment of your time today provides you with new knowledge, insight and contacts. We welcome your feedback and will be providing a post-event survey via email.

Sincerely,
Leigh Anna and Carolynne
Co-Chairs, Promising Pathways Planning Committee

Ms. Leigh Anna Nowak
CARD Consultant
Center for Autism and Related Disabilities
239-590-7769
lnowak@fgcu.edu

Dr. Carolynne Gischel
Special Education Faculty
Florida Gulf Coast University
239-590-7795
cgischel@fgcu.edu

Conference Committee:

Lourdes Araujo
Armando Galella
Elly Hagen
Amanda Hall
Duska Hepner
Lynn James
Scott Kozlowski
Jackie McNulty
Terri Myles
Debbi Nicolosi
Kelly Powell
Dr. Joanna Salapska-Gelleri
Dr. Britt Stroud
Margaret Sullivan

David Lawrence Center
Naples Children & Education Foundation
Parent & elly hagen marketing & pr
WINK News
Florida's State Personnel Development Grant
Parent & Family Care Council
Collier County Public Schools
FGCU College of Education
The School District of Lee County
TATS - Technical Assistance & Training System
Parent
FGCU College of Arts and Sciences
Golisano Children's Hospital of SW Florida
Florida's State Personnel Development Grant

Conference Agenda

KEYNOTE: Chantal Sicile-Kira



We are pleased to welcome our keynote speaker, Chantal Sicile-Kira, author, speaker, consultant, and founder of Autism College. Chantal's passion for empowering others, her love of writing, and her personal interest in autism has led her to become a leader in the field of adolescence and transition to adulthood, and an international speaker and award-winning author of five books. Having worked with individuals with autism in California, and then raising her son Jeremy in three different countries, gives her a perspective few in the field have. Chantal recently founded AutismCollege.com which provides practical information and training on-line for parents and educators. Chantal served on the Taskforce on Transitional Services & Supports reporting to the California Legislative Blue Ribbon Commission on Autism, and was appointed by the California Senate elect Autism Committee to co-chair the South Counties Autism Regional Taskforce. Chantal's recent awards include the 2013 Jo Pike Believe Award from the National Autism Association; and being named a 2013 Top Ten Autism Blogger and Social Health-Maker by Sharecare. Chantal and her family have been featured in the MTV documentary "True Life" series and a wide variety of media, including NPR, PBS, *The Chicago Tribune*, Newsweek (cover article), and Fox News.

8:00—9:00	Onsite Registration and Vendor Exhibits; Cohen Center Gallery
9:00—10:45	Keynote Presentation; Cohen Center Ballroom Introductions Amanda Hall, WINK News Welcome Dr. Ronald Toll Provost and Vice-President for Academic Affairs Florida Gulf Coast University Keynote Introduction Dr. Robert Gregerson, Dean & Professor FGCU College of Arts & Sciences Keynote Speaker Chantal Sicile-Kira
10:45—11:00	Break & Vendor Exhibits
11:00—12:00	Concurrent Session 1
12:00—1:00	Lunch & Vendor Exhibits; Cohen Center Gallery <i>Pre-purchased lunches will be distributed on lower level.</i> Keynote Book Signing 12:30—1:00 FGCU Bookstore Entry
1:00—2:00	Concurrent Session 2
2:00—2:15	Break & Vendor Exhibits
2:15—3:15	Concurrent Session 3

Concurrent with Keynote – 9:15AM - 10:45AM

Title	Topic	Presenters	Location
How Do Special Education Services Relate to Your Child? <i>Delivered in Spanish</i> <i>Not eligible for CEUs</i>	Education	Margarita Montalvo, Co-Director Family Network on Disabilities Parent Education Center	Cohen Center 162

Cohen Center



First Floor

Business Operations	152
Campus Conference Programs	145
Campus Reservations	145
Career Development Services	161
Division of Student Affairs	104
Eagle ID Card Office	152
Information Booth	101
Records Management	145
Career Services Training Room	162
Einstein Bros. Bagels	111
Food Court	116
FGCU Bookstore	132



Second Floor

Dean of Students Office	288
Multicultural Student Services Center	255
Student Conduct	288
Student Government	254
Student Involvement	258A
Fraternity and Sorority Life	259
Programming Board	253
Registered Student Organizations	252
Student Leadership Development	280
Charter Meeting Room	247
Dean of Students Office Conference Room	286
Leadership Conference Room	249
Multi-purpose Room	213
Fogg Lakeview Suite	214
Service Conference Room	246
Spirit Conference Room	245
Student Involvement Center	257
Student Lounge	261
Ballroom	203
Terrace	203A

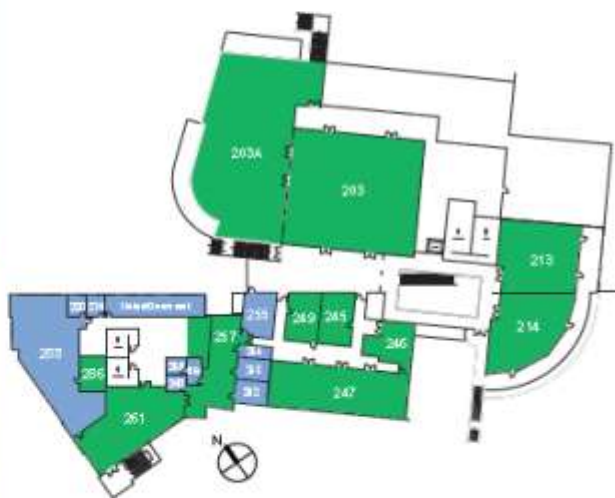

Concurrent Session 1

11:00AM - 12:00PM

Title	Topic	Presenters	Location
Adolescents on the Autism Spectrum	Social/Behavioral	Chantal Sicile-Kira, Author, Speaker, Consultant Founder, Autism College	Cohen Center Ballroom
Preparing for Post-secondary education	Transition/ Adult Living	Deborah Chamberlin, MA, EDS, ESE Liaison Patricia A. Williams, MA, Educational Consultant/Academic Coach	Cohen Center 213
Assessment and Treatment of High Functioning Autism in Children <i>Part 1 of 2</i>	Communication/ Social Skills	Ellen Hemrick, MS CCC-SLP Charlene Westman, MA CCC-SLP	Cohen Center 214
Exploring Autism Spectrum Disability and Employment	Employment/ Adult Living	Ms. Susan Richmond Karen Berkman, PhD.	Cohen Center 247B
Using DIR/Floortime to Improve Instructional Strategies at Every Level	Instructional Strategies	Dr. Jennie Trocchio	Cohen Center 247C
Your Guide to an IEP That Works <i>Delivered in Spanish Not eligible for CEUs</i>	Education	Margarita Montalvo, Co-Director Family Network on Disabilities Parent Education Center	Cohen Center 162
Increasing Student Engagement through Instructional Supports and Accommodations for Learning	Instructional Strategies	Mr. David Davis Technology & Learning Connections – PS/RtI	Griffin Hall 107
I want to work and I need Support - How can I have the support I need? <i>Not eligible for CEUs</i>	Supported Employment Services	Idela Hernandez, M.S.; CRC; CWIC	Griffin Hall 109
Autism: Legal and Financial Implications	Life Planning	Dr. Jess W. Levins, Esquire, PE, CMA, CFM	Griffin Hall 172

Concurrent Session 2

1:00PM - 2:00PM

Title	Topic	Presenters	Location
How Do Special Education Services Relate to Your Child? <i>Not eligible for CEUs</i>	Education	Clara Alevy, Parent Resource Specialist Family Network on Disabilities Parent Education Center	Cohen Center Ballroom
Journey to Success: Navigating the Neurotypical Working World <i>Featured Speaker*</i>	Employment/ Adult Living	Mr. Bradford S Karpel	Cohen Center 213
Assessment and Treatment of High Functioning Autism in Children <i>Part 2 of 2</i>	Communication/ Social Skills	Ellen Hemrick, MS CCC-SLP Charlene Westman, MA CCC-SLP	Cohen Center 214
Exploring Autism Spectrum Disability and Employment	Employment/ Adult Living	Ms. Susan Richmond Karen Berkman, PhD.	Cohen Center 247B
Autism: Legal and Financial Implications	Life Planning	Dr. Jess W. Levins, Esquire, PE, CMA, CFM	Cohen Center 247C
Positive Behavioral Supports <i>Delivered in Spanish</i> <i>Not eligible for CEUs</i>	Positive Behavior Support	Yolanda Ruiz, M.Ed., Intensive Reading ESOL Teacher , Former Teacher of Students with Severe Disabilities Lee County School District	Cohen Center 162
Increasing Student Engagement through Instructional Supports and Accommodations for Learning	Instructional Strategies	Mr. David Davis Technology & Learning Connections – PS/RtI	Griffin Hall 107
Using DIR/Floortime to Improve Instructional Strategies at Every Level	Instructional Strategies	Dr. Jennie Trocchio	Griffin Hall 109

**Featured Speakers have been invited to present first hand experiences of individuals living with autism.*

Concurrent Session 3

2:15PM - 3:15PM

Title	Topic	Presenters	Location
Your Guide To An IEP That Works <i>Not eligible for CEUs</i>	Education	Clara Alevy, Parent Resource Specialist Family Network on Disabilities Parent Education Center	Cohen Center Ballroom
Journey to Success: Navigating the Neurotypical Working World <i>Featured Speaker*</i>	Employment/ Adult Living	Mr. Bradford S Karpel	Cohen Center 213
Preparing for Post-secondary education	Transition/ Adult Living	Deborah Chamberlin, MA, EDS, ESE Liaison Patricia A. Williams, MA, Educational Consultant/Academic Coach	Cohen Center 214
Positive Behavioral Supports <i>Not eligible for CEUs</i>	Positive Behavior Support	Yolanda Ruiz, M.Ed., Intensive Reading ESOL Teacher , Former Teacher of Students with Severe Disabilities Lee County School District	Cohen Center 247B
I want to work and I need Support - How can I have the support I need? <i>Delivered in Spanish</i> <i>Not eligible for CEUs</i>	Supported Employment Services	Idela Hernandez, M.S.; CRC; CWIC	Cohen Center 162
Picky Eaters vs. Problem Feeders	Feeding/ Social Skills	Ellen Hemrick, MS CCC-SLP Ms. Charlene Westman, MA CCC-SLP Kasey Silverman, BFA, SLPA	Griffin Hall 107



a conference for families, educators, and health care professionals addressing autism spectrum disorders

Thank you for attending the Promising Pathways Conference!
You will receive a survey at your registration email address. Please take a moment to complete the survey and provide feedback on this year's conference. Your feedback will inform us as we plan future conferences. We look forward to seeing you again at the 9th Annual Conference on Best Practice in Autism in April 2016!

2015 Promising Pathways Planning Committee

**Featured Speakers have been invited to present first hand experiences of individuals living with autism.*

Session Descriptions

Adolescents on the Autism Spectrum

Social/Behavioral

Adolescence is a difficult time for everyone, neurotypical or not, as a person transitions from being a child to a young adult. To become as independent in adulthood as possible, teenagers of all different ability levels must learn self-care, appropriate behaviors, modesty and sexuality. Areas to be covered include: explaining about puberty and changing bodies, hygiene and self-care and how to problem-solve difficulties in teaching self-care routines, the importance of modesty, and what to do about masturbation. For safety reasons and in preparation for adulthood, all teenagers need to learn about relationship boundaries, and sexuality. Ideas for preventing bullying and abuse will be discussed.

*Chantal Sicile-Kira, Author, Speaker, Consultant
Founder, Autism College*

Assessment and Treatment of High Functioning Autism in Children

Communication/Social Skills

Many children with High Functioning Autism (HFA) have severe social impairment yet score “normally” on standardized measures of achievement. They exhibit behaviors, emotional reactions, and learning styles that interfere with functioning in school and everyday life. Despite concomitant disorders such as ADHD, OCD, or depression, the underlying ASD requires specialized assessment and treatment.

Delivered in two sessions as Part 1 and Part 2.

*Ellen Hemrick, MS CCC-SLP &
Charlene Westman, MA CCC-SLP*

Autism: Legal and Financial Implications

Life Planning

The presentation will cover the legal and financial opportunities that are available from birth to death for a special needs individual including topics such as SSI, SSD, Pre-Need Guardianship, Guardian Advocate, Guardianship, the procedure to qualify for both Medicare & Medicaid, Special Needs Trust, Group Homes, and the ability of the special needs child to collect against the parents' social security for the rest of the child's life.

Dr. Jess W. Levins, Esquire, PE, CMA, CFM

Exploring Autism Spectrum Disability and Employment

Employment/Adult Living

Participants will be provided with the latest employment data regarding individuals with an autism spectrum disability, best practice in supporting individuals with an ASD in employment and information about a model program achieving remarkable results for individuals in the area of employment.

*Ms. Susan Richmond
Karen Berkman, PhD.*

Session Descriptions

How Do Special Education Services Relate to Your Child?

Education

Every child is entitled to FAPE, a Free and Appropriate Public Education in the least restrictive environment. Related Services make FAPE possible, and for your child to learn alongside their peers. In this session, you will learn what type of services are available, qualifying for services, and how to get started.

English and Spanish Sessions

Clara Alevy, Parent Resource Specialist (English Session)

Margarita Montalvo, Co-Director (Spanish Session)

Family Network on Disabilities, Parent Education Center

I want to work and I need Support - How can I have the support I need?

Supported Employment Services

If you have a disability and wish to take up paid employment or you require assistance in finding a job, Interpreting & Application Services, LLC may be able to help you. We serve individuals with disabilities with necessary supports to help them access employment. In this presentation we will discuss "what is Supported Employment and how can it be funded?"

English and Spanish Sessions

Idela Hernandez, M.S.; CRC; CWIC

Increasing Student Engagement through Instructional Supports and Accommodations for Learning

Instructional Strategies

The use of instructional supports and accommodations to scaffold implied skills can be critical in supporting a student's academic achievement. Technology provides a diverse array of tools and apps that students can use to support reading, task persistence, sequencing and organizing information, and other implied skills. This presentation will review cognitive processes related to reading, organizing information, memory, and demonstrating understanding. We will then explore strategies and technology tools that can be used as instructional supports and accommodations in the classroom and at home. Participants will receive a free Teacher Resource CD with tools and information that can be quickly used to support student achievement.

Mr. David Davis, Technology & Learning Connections – PS/RtI

Journey to Success: Navigating the Neurotypical Working World

Employment/Adult Living

The speaker, an adult with autism spectrum disorder, will use some of his own experiences to focus on the resources, tools and strategies that may be used to become successful in a neuro-typical workforce.

*Mr. Bradford S Karpel, Featured Speaker**

**Featured Speakers have been invited to present first hand experiences of individuals living with autism.*

Session Descriptions

Picky Eaters vs. Problem Feeders

Feeding/Social Skills

How can you expand your child's diet to improve nutrition, intake, and variety? Addressing extreme inflexibility is the first step. Using food chaining, food diaries, and activities throughout the home environment, your child can become a successful eater. Group discussion and activities will be accompanied by nutritional resources and helpful recipe ideas.

Ellen Hemrick, MS CCC-SLP

Ms. Charlene Westman, MA CCC-SLP

Kasey Silverman, BFA, SLPA

Positive Behavioral Supports

Social/Behavioral

Positive behavior supports are designed to help individuals know what is expected and provide reinforcement for improvements in behavior. This session will provide an overview of positive behavior supports and specific strategies for implementation.

English and Spanish Sessions

Yolanda Ruiz, M.Ed., Intensive Reading ESOL Teacher ,

Former Teacher of Students with Severe Disabilities

Lee County School District

Preparing for Post-secondary education

Transition/Adult Living

An interactive workshop that looks at steps to prepare students on the Autism spectrum (and others) to transition to college by developing a 5 year plan (8th – 12th) and finding the right college environment. This workshop also spotlights key transition issues and compensatory strategies to address situations found on college campuses.

Ms. Deborah Chamberlin, MA, EDS, ESE Liaison

Ms. Patricia A. Williams, MA, Educational Consultant/Academic Coach

Using DIR/Floortime to Improve Instructional Strategies at Every Level

Instructional Strategies

The Developmental, Individual Differences and Relationship based (DIR/Floortime) approach to intervention provides a practical model that helps clinicians and parents comprehensively assess and create an intervention program, tailored to the individual strengths and challenges of each child. Instructional strategies utilized promote independent thinking, problem solving, and independence at every level.

Dr. Jennie Trocchio

Your Guide To An IEP That Works

Education

Developing and implementing an IEP (Individual Education Plan) is the equal responsibility of educators, parents, and other members of the IEP team. This session will explain the IEP process, and the importance of parental participation. Helpful tips for writing effective IEP goals and strategies will be provided.

English and Spanish Sessions

Clara Alevy, Parent Resource Specialist (English Session)

Margarita Montalvo, Co-Director (Spanish Session)

Family Network on Disabilities, Parent Education Center

Campus Map

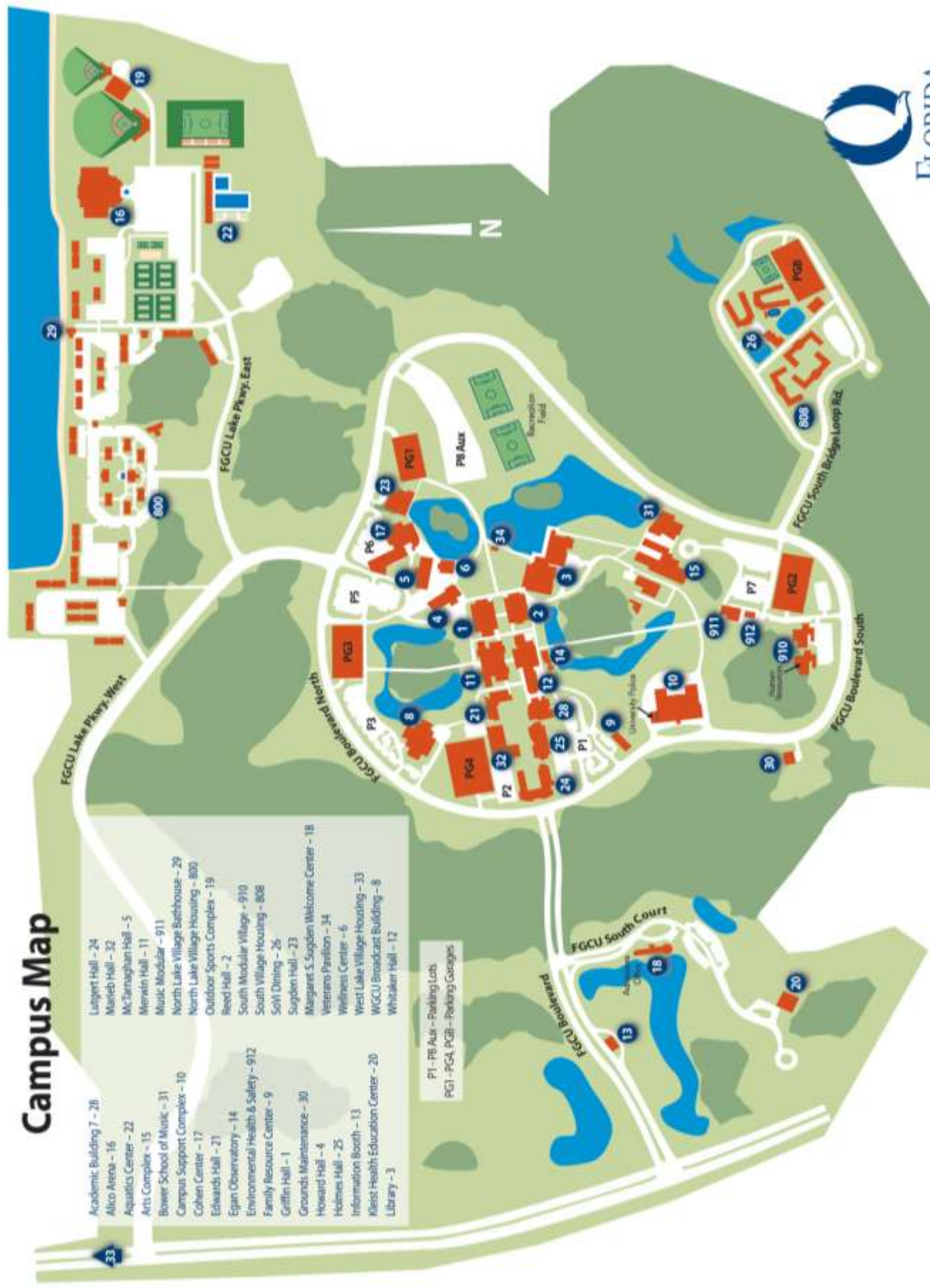

- Academic Building 7 - 28
- Alto Arena - 16
- Aquatics Center - 22
- Arts Complex - 15
- Bower School of Music - 31
- Campus Support Complex - 10
- Cohen Center - 17
- Edwards Hall - 21
- Egan Observatory - 14
- Environmental Health & Safety - 912
- Family Resource Center - 9
- Griffin Hall - 1
- Grounds Maintenance - 30
- Howard Hall - 4
- Holmes Hall - 25
- Information Booth - 13
- Kleiss Health Education Center - 20
- Library - 3
- Lupton Hall - 24
- Marleb Hall - 32
- McTearaghan Hall - 5
- Merwin Hall - 11
- Music Modular - 911
- North Lake Village Bathroom - 29
- North Lake Village Housing - 800
- Outdoor Sports Complex - 19
- Reed Hall - 2
- South Modular Village - 910
- South Village Housing - 808
- SOVI Dining - 25
- Suggden Hall - 23
- Margaret S. Suggden Welcome Center - 18
- Veterans Pavilion - 34
- Wellness Center - 6
- West Lake Village Housing - 33
- WGCU Broadcast Building - 8
- Whitaker Hall - 12

P1 - PB Aux - Parking Lots
 PGI - PGA, PGB - Parking Garages



*Griffin Hall is building 1 and is southwest of Cohen Center

Special Thanks to Our 2015 Conference Sponsors:

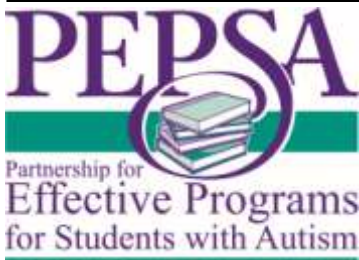

The Promising Pathways Planning Committee does not endorse any specific vendor or sponsor. Vendors are exhibiting to help you with your search for programs and practices for people with autism spectrum disorder and related disabilities.